

CAVALIO LOC 0.55

1. GENERAL INFORMATION

When installing CAVALIO LOC 0.55 always follow current standards for the installation of floorcoverings (VOB, Part C, DIN 18365 in Germany and other relevant national standards), also best current installation practice incorporating the latest technical developments should be employed.

The preparation of the subfloor, the installation of the floorcovering and the measures taken to safeguard value are key factors in ensuring optimum suitability and performance of resilient floorcoverings.

Please also consult our instructions for cleaning and care.

On receipt of materials, check that colours correspond to those ordered and that there is no damage or visual defects in the material. In particular, check that the material is from one batch. Claims for visual defects can only be accepted prior to installation and cutting.

2. PREPARATION OF SUBFLOORS

CAVALIO LOC 0.55 can be laid on mineral subfloors prepared in accordance with accepted trade standards. It must be clean, durable, permanently dry and flat. It can be laid directly on existing floor coverings of ceramic, vinyl and linoleum as long as they are clean, flat and there is no dampness under the floor covering. It can be laid over wooden floors, floorboards and chipwood floors as long as they are flat, firmly fastened and free of protruding nails etc.

We recommend that you use our approved VINYL LOC sound-proofing underlay to reduce noise from footsteps.

Existing installed carpeting or needle-punched felt is unsuitable as a base for the installation of floating flooring. This will need to be removed first.

In installations where underfloor heating is used, current standards should be followed (Germany: DIN 18365 and EN 1264-2). Maximum working temperature on the surface of the flooring is 27° C.

Residual moisture content:

Cement screed	max. 2.0 CM %
With underfloor heating	1.8 CM %
Anhydrite floor	max. 0.5 CM %
With underfloor heating	0.3 CM %

3. INSTALLATION

The parcels of flooring must be protected against dirt and moisture during storage and installation. The climatic conditions must be observed as follows:

Floor temperature	> 15 °C
Room temperature	> 18 °C
Relative humidity	< 50–60 %

Prior to laying the floor, place the closed packages of material that is to be installed into the room in which it is to be installed for 48 hours so the material can acclimatise itself.

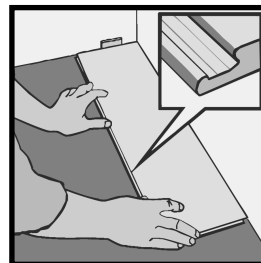

a. Make sure that a expansion gap is kept of at least 4 mm to the walls as well as to all fixed components (doorframes, heating pipes etc.). The flooring must not be fitted straight onto built-in furniture or fixtures such as kitchenettes. In the case of room sizes over 10 m x 10 m, suitable expansion profiles must be inserted.

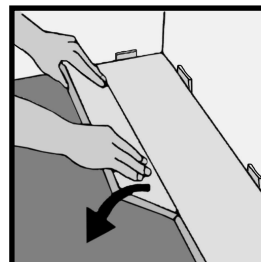

b. The boards are laid **without** glue/ adhesive.

Start to lay the floor in the left-hand corner of the room. The first board is aligned while observing the minimum distances to the wall. The second board and further boards are locked in place at the ends. While doing this, ensure that the long sides are not misaligned. It is advisable to check this by placing a left-over piece alongside them. Further rows of boards must be offset by at least 30 cm to the short edge joints of the previous rows.

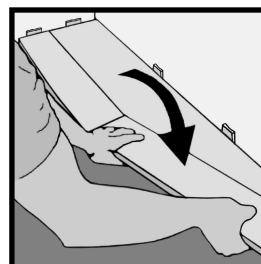

The next elements are interlocked initially along the short side. The long side is interlocked by tilting the plank at a slight angle until the entire row is in the correct position.

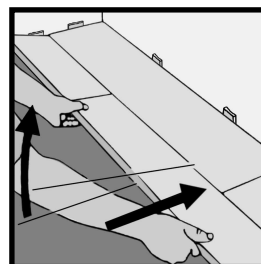

CAVALIO LOC 0.55

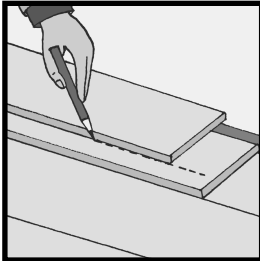

c. When cutting the last row of boards ensure a 4 mm expansion gap is left. A pull bar will be needed to tap the boards into position. When complete, remove **any** spacers, cut any PE foil flush with the top of the boards and fit skirting boards. Ensure the skirting boards do not restrict the movement of the flooring.

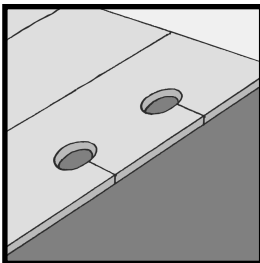

d. Heating pipes and recesses must be sawn, cut or drilled into the elements for heating pipes, taking the expansion spacing of 4 mm into consideration.

Rosettes are used for covering.

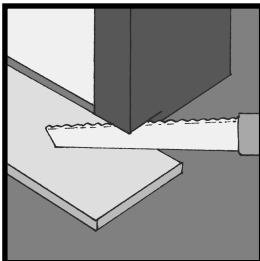

e. Wooden doorframes can be shortened. Take the necessary expansion spacing of at least 4 mm **under** the doorframe into account. The elements' freedom of movement may not be impaired through shortening the frames. If doorframes are not shortened an expansion gap of at least 4 mm is to be kept.

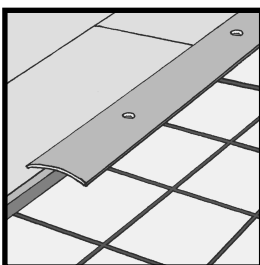

f. When laying in several rooms, separate the surfaces in the door or passage areas. These and the crossovers to other floorcoverings must be covered using the suitable system profiles.

4. COMPLETION WORK

The floor covering can be walked on directly after it is installed.

Remove all the spacers and wedges. Edge expansion gaps should be covered using suitable skirting; when doing so, ensure that this is not fastened into the floor itself.

Install suitable system profiles, making sure that these allow for movement of the flooring.

5. INSTRUCTIONS

CAVALIO LOC 0.55 has only been designed for indoor use. The preferred atmospheric conditions are approx. 50–60% humidity and a temperature of 18–26 °C. This should be maintained at all times. Long periods of deviation from these atmospheric conditions could lead to a change in the product's dimensions or the appearance of gaps, etc.

CAVALIO LOC 0.55 is not suitable as a flooring in areas that are subject to strong heat, e.g. direct sunlight (floor-to-ceiling windows or ceiling windows).

For further guidance contact our Customer Technical Support.